

1-800-GET-EAGLE  
1-800-438-3245



# Mobile Office Solutions



[eagleleasing.com](http://eagleleasing.com)  
[info@eagleleasing.com](mailto:info@eagleleasing.com)



1-800-GET-EAGLE  
1-800-438-3245

You See Us Everywhere®

## 10' Office Container (Guard Shack)

[eagleleasing.com/get-a-quote](http://eagleleasing.com/get-a-quote)

**Run your business on-site with Eagle Leasing's mobile office solutions.**

### Size

- 10' x 8' x 8'6" steel ISO container
- Weight: 5,027 lbs

### Interior

- (1) Built-in counter top desk (30" x 96")
- (1) Filing cabinet
- Pebbled fiberglass interior wall panels
- Marine grade plywood floor with epoxy finish

### Electric

- Air conditioning & heat
- 125 amp, 208/220 volt breaker panel
- Interior & exterior lights
- 2 outlets (4 plugs)
- 1 phone jack

### Exterior

- Reinforced corrugated steel
- (2) Windows with security bars
- Lockable steel exterior door with door closer
- (1) GFI outlet (2 plugs)

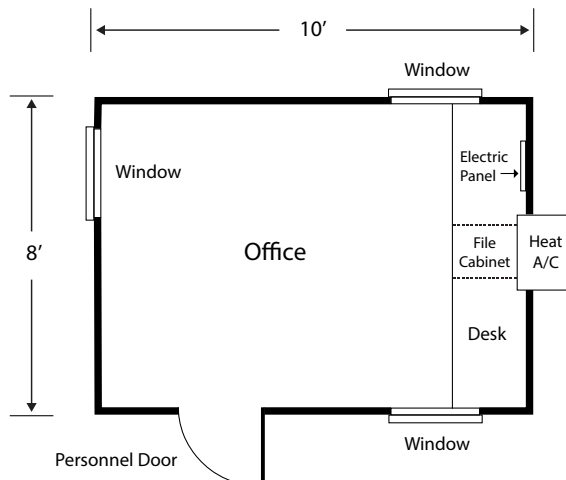

\* Photos are representational. Specifications may vary from those shown.

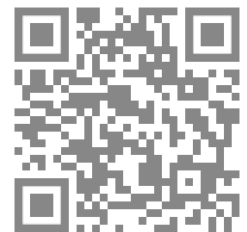

[eagleleasing.com/guard-shacks](http://eagleleasing.com/guard-shacks)



1-800-GET-EAGLE  
1-800-438-3245

You See Us Everywhere®

## 20' Office Container

[eagleleasing.com/get-a-quote](http://eagleleasing.com/get-a-quote)

### Run your business on-site with Eagle Leasing's mobile office solutions.

#### Size

- 20' x 8' x 8'6" steel ISO container
- Weight : 7,079 lbs

#### Interior

- (1) Built-in counter top desk (30" x 96")
- (1) Filing cabinet
- (1) Folding plan table (32" x 60")
- Pebbled fiberglass interior wall panels
- Marine grade plywood floor with epoxy finish

#### Electric

- Central air conditioning & heat
- 125 amp, 208/220 volt breaker panel
- Interior & exterior lights
- 4 outlets (12 plugs)
- 1 phone jack

#### Exterior

- Reinforced corrugated steel
- (4) Windows with security bars
- Lockable steel exterior door with door closer
- (1) GFI outlet (2 plugs)

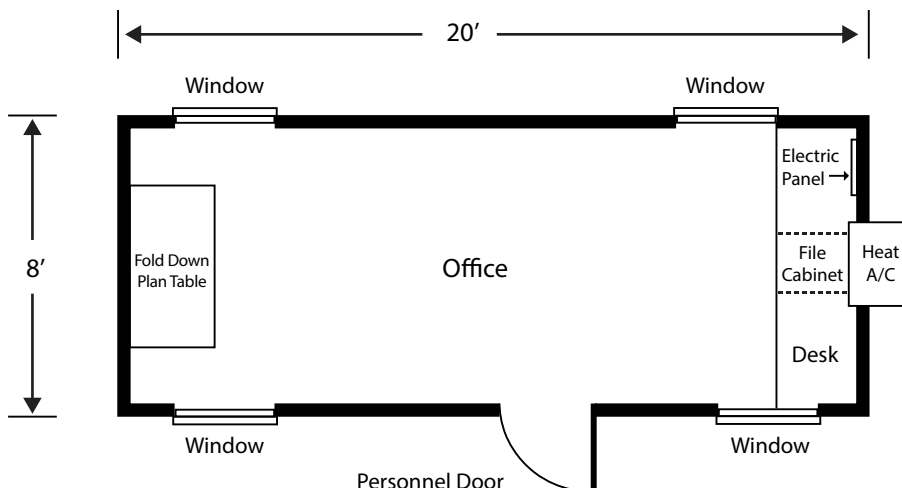

\* Photos are representational. Specifications may vary from those shown.



[eagleleasing.com/20-office-containers](http://eagleleasing.com/20-office-containers)



1-800-GET-EAGLE  
1-800-438-3245

You See Us Everywhere®

## 20' Office/Storage Container

[eagleleasing.com/get-a-quote](http://eagleleasing.com/get-a-quote)

**Run your business on-site with Eagle Leasing's mobile office solutions.**

### Size

- 20' x 8' x 8'6" steel ISO container
- Weight: 6,435 lbs
- 10' of storage space
- 10' of office space

### Interior

- (1) Built-in counter top desk (30" x 96")
- (1) Filing cabinet
- (1) Folding plan table (32" x 60")
- Pebbled fiberglass interior wall panels
- Marine grade plywood floor with epoxy finish
- Steel interior door

### Electric

- Air conditioning & heat
- 125 amp, 208/220 volt breaker panel
- Interior & exterior lights
- 3 outlets (10 plugs)
- 1 phone jack

### Exterior

- Reinforced corrugated steel
- (2) Windows with security bars
- Lockable steel exterior door with door closer
- (1) GFI outlet (2 plugs)



### Accessories

Eagle Locks®  
Shelves  
Pipe Racks  
Container Ramps  
Fork Truck Ramps

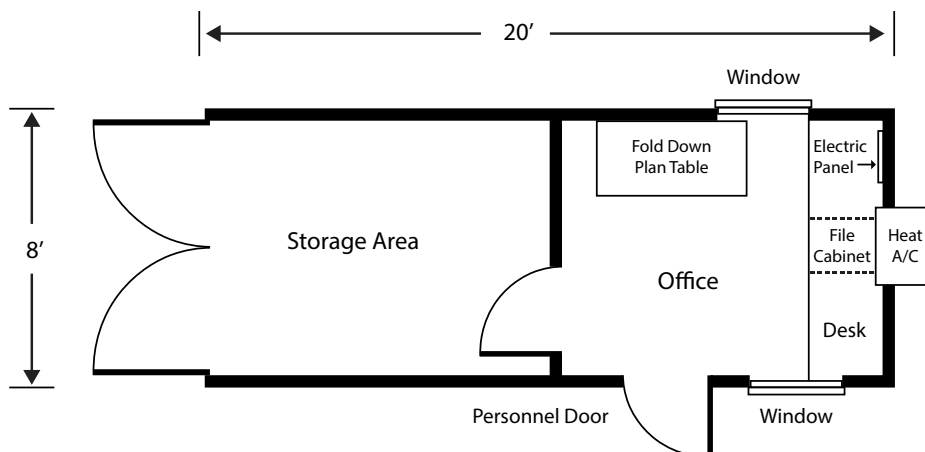

\* Photos are representational. Specifications may vary from those shown.



[eagleleasing.com/20-office-storage-container](http://eagleleasing.com/20-office-storage-container)

The Eagle Leasing Company  
1-800-438-3245 - [info@eagleleasing.com](mailto:info@eagleleasing.com) - [eagleleasing.com](http://eagleleasing.com)  
Orange, CT - Southborough, MA - Oxford, MA - Northborough, MA



1-800-GET-EAGLE  
1-800-438-3245

You See Us Everywhere®

## 20' Open Office

[eagleleasing.com/get-a-quote](http://eagleleasing.com/get-a-quote)

## Run your business on-site with Eagle Leasing's mobile office solutions.

### Size

- 20' x 8' x 8'6" steel ISO container
- Weight : 6,979 lbs

### Interior

- Pebbled fiberglass interior wall panels
- Marine grade plywood floor with epoxy finish

### Electric

- Central air conditioning & heat
- 125 amp, 208/220 volt breaker panel
- Interior & exterior lights
- 4 outlets (12 plugs)
- 1 phone jack

### Exterior

- Reinforced corrugated steel
- (4) Windows with security bars
- Lockable steel exterior door with door closer
- (1) GFI outlet (2 plugs)



[eagleleasing.com/20-office-containers](http://eagleleasing.com/20-office-containers)

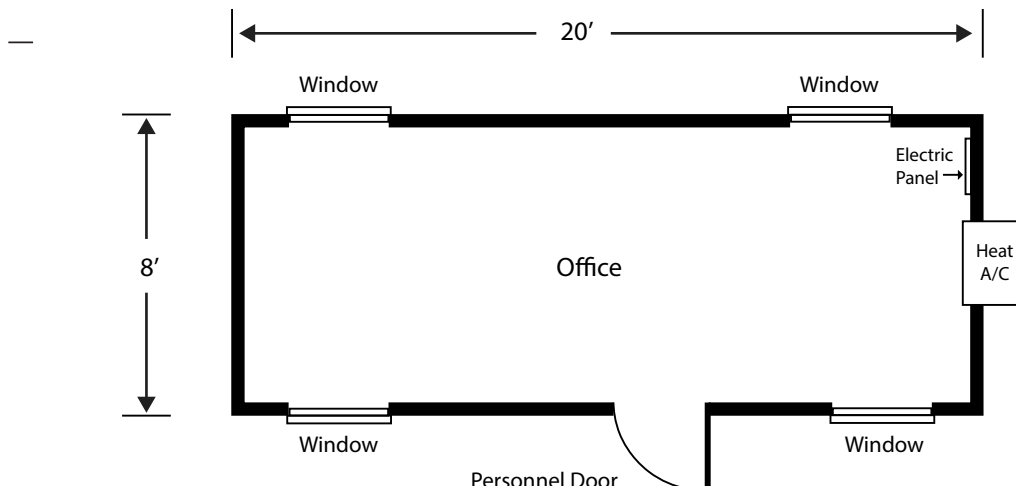

\* Photos are representational. Specifications may vary from those shown.





1-800-GET-EAGLE  
1-800-438-3245

You See Us Everywhere®

## 40' Office/Storage Container

[eagleleasing.com/get-a-quote](http://eagleleasing.com/get-a-quote)

Run your business on-site with Eagle Leasing's mobile office solutions.

### Size

- 40' x 8' x 9'6" steel ISO container
- Weight: 11,103 lbs
- 25' of storage space
- 15' of office space

### Electric

- Air conditioning & heat
- 125 amp, 208/220 volt breaker panel
- Interior & exterior lights
- 3 outlets (10 plugs)
- 1 phone jack

### Interior

- (1) Built-in counter top desk (30" x 96")
- (1) Filing cabinet
- (1) Folding plan table (32" x 60")
- Pebbled fiberglass interior wall panels
- Marine grade plywood floor with epoxy finish
- Steel interior door

### Exterior

- Reinforced corrugated steel
- (2) Windows with security bars
- Lockable steel exterior door with door closer
- (1) GFI outlet (2 plugs)

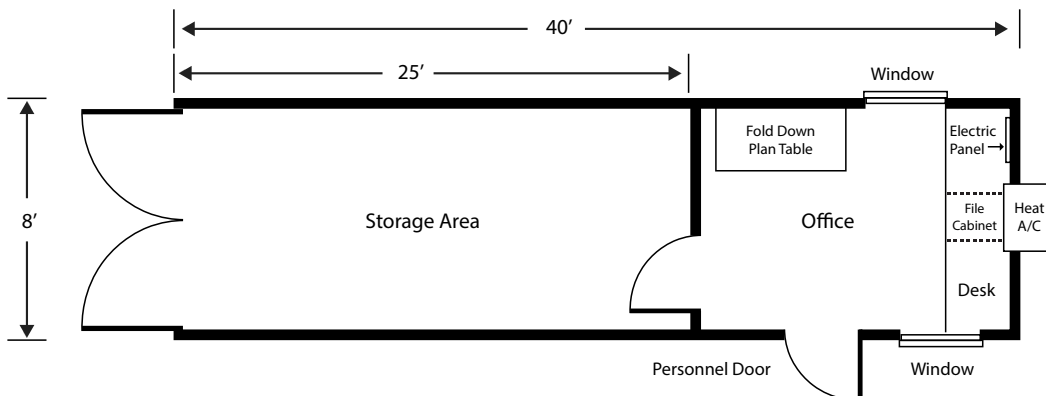

### Accessories

Eagle Locks®  
Shelves  
Pipe Racks  
Container Ramps  
Fork Truck Ramps



\* Photos are representational. Specifications may vary from those shown.

[eagleleasing.com/40-office-storage-container](http://eagleleasing.com/40-office-storage-container)

The Eagle Leasing Company  
1-800-438-3245 - [info@eagleleasing.com](mailto:info@eagleleasing.com) - [eagleleasing.com](http://eagleleasing.com)  
Orange, CT - Southborough, MA - Oxford, MA - Northborough, MA



1-800-GET-EAGLE

1-800-438-3245

You See Us Everywhere®

## 40' Triple Office Container

[eagleleasing.com/get-a-quote](http://eagleleasing.com/get-a-quote)

Run your business on-site with Eagle Leasing's mobile office solutions.

### Size

- 40' x 8' x 9'6" steel ISO container
- Weight: 14,148 lbs

### Electric

- Central air conditioning & heat
- 125 amp, 208/220 volt breaker panel
- Interior & exterior lights
- 10 outlets (28 plugs)
- 2 phone jack

### Interior

- (2) Built-in counter top desks (30" x 96")
- (2) Filing cabinets
- (1) Folding plan table (32" x 60")
- Pebbled fiberglass interior wall panels
- Marine grade plywood floor with epoxy finish
- (2) Steel interior doors

### Exterior

- Reinforced corrugated steel
- (6) Windows with security bars
- (2) Lockable steel exterior doors with door closers
- (1) GFI outlet (2 plugs)

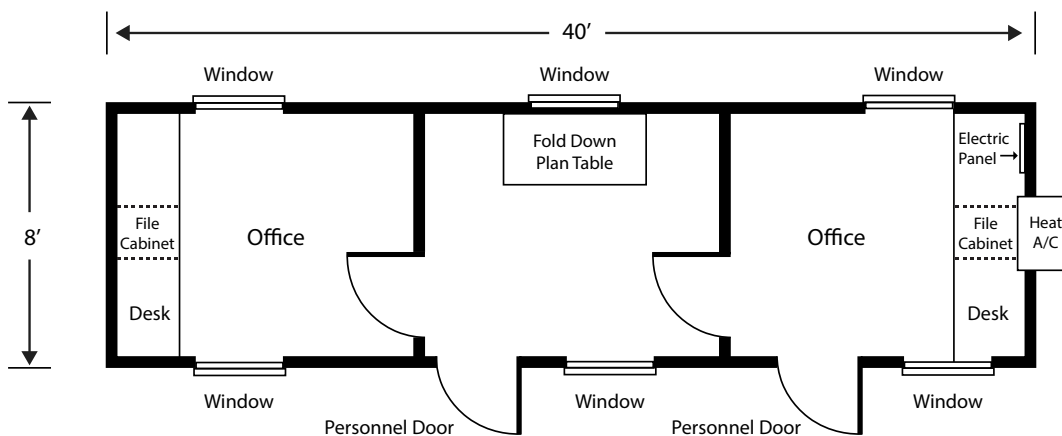

\* Photos are representational. Specifications may vary from those shown.



[eagleleasing.com/40-triple-office-container](http://eagleleasing.com/40-triple-office-container)

The Eagle Leasing Company

1-800-438-3245 - [info@eagleleasing.com](mailto:info@eagleleasing.com) - [eagleleasing.com](http://eagleleasing.com)

Orange, CT - Southborough, MA - Oxford, MA - Northborough, MA



1-800-GET-EAGLE  
1-800-438-3245

You See Us Everywhere®

## 40' Open Office

[eagleleasing.com/get-a-quote](http://eagleleasing.com/get-a-quote)

## Run your business on-site with Eagle Leasing's mobile office solutions.

### Size

- 40' x 8' x 9'6" steel ISO container
- Weight: 12,247 lbs

### Interior

- (1) Built-in counter top desks (30" x 96")
- (1) Filing cabinets
- Pebbled fiberglass interior wall panels
- Marine grade plywood floor with epoxy finish

### Electric

- Central air conditioning & heat
- 125 amp, 208/220 volt breaker panel
- Interior & exterior lights
- 8 outlets (20 plugs)
- 2 phone jack

### Exterior

- Reinforced corrugated steel
- (5) Windows with security bars
- (2) Lockable steel exterior doors with door closers
- (1) GFI outlet (2 plugs)

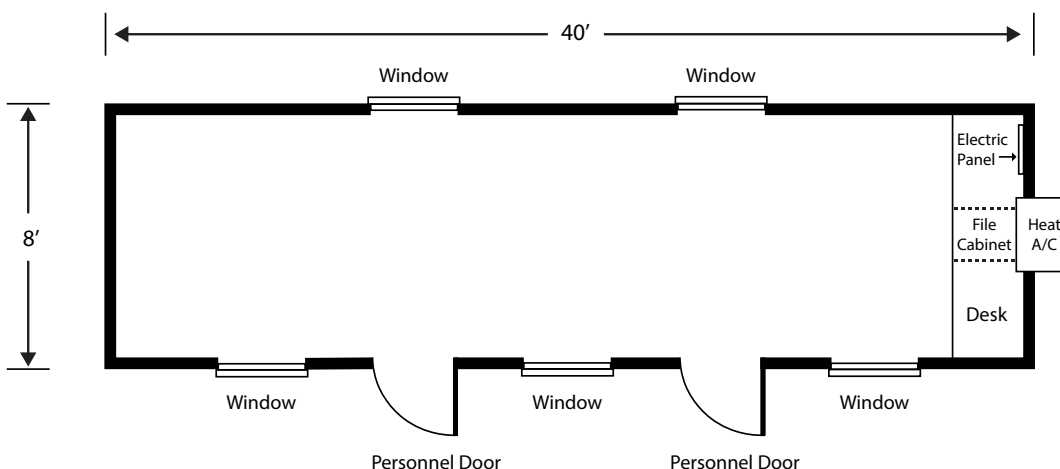

\* Photos are representational. Specifications may vary from those shown.





1-800-GET-EAGLE  
1-800-438-3245

You See Us Everywhere®

## 40' Breakroom Container

[eagleleasing.com/get-a-quote](http://eagleleasing.com/get-a-quote)

Run your business on-site with Eagle Leasing's mobile office solutions.

### Size

- 40' x 8' x 8'6" steel ISO container
- Weight: 12,247 lbs

### Interior

- Pebbled fiberglass interior wall panels
- Marine-grade plywood floor with epoxy finish

### Electric

- Central air conditioning & heat
- 125 amp, 208/220-volt breaker panel
- Interior & exterior lights
- 6 outlets (12 plugs)

### Exterior

- Reinforced corrugated steel
- (2) Lockable steel exterior door
- (1) GFI outlet (2 plugs)

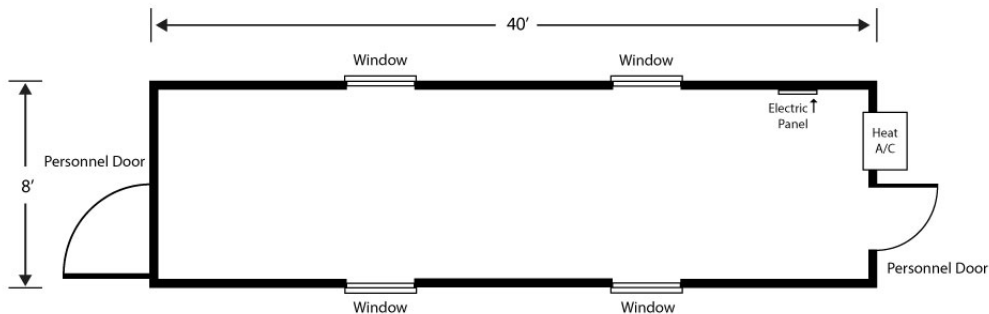

[eagleleasing.com/breakroom-container](http://eagleleasing.com/breakroom-container)

\* Photos are representational. Specifications may vary from those shown.

The Eagle Leasing Company  
1-800-438-3245 - [info@eagleleasing.com](mailto:info@eagleleasing.com) - [eagleleasing.com](http://eagleleasing.com)  
Orange, CT - Southborough, MA - Oxford, MA - Northborough, MA



1-800-GET-EAGLE

1-800-438-3245

You See Us Everywhere®

## 8'x20' Single Office Trailer

[eagleleasing.com/get-a-quote](http://eagleleasing.com/get-a-quote)

**Run your business on-site with Eagle Leasing's mobile office solutions.**

### Size

- 8' x 20' trailer with 4' hitch
- Weight: 3,900 lbs

### Electric

- Air conditioning and baseboard heating
- 100 amp, 120 volt breaker panel
- Interior ceiling lights
- 5 outlets (10 plugs)

### Interior

- (1) Built-in counter top desk (24" x 88")
- (1) Filing cabinet
- (1) Fold down planning table (36" x 60")
- (1) Wire shelf

### Exterior

- Aluminum siding
- (3) Windows with metal security screens
- (1) Lockable steel exterior door
- (1) Set of aluminum stairs (preassembled)

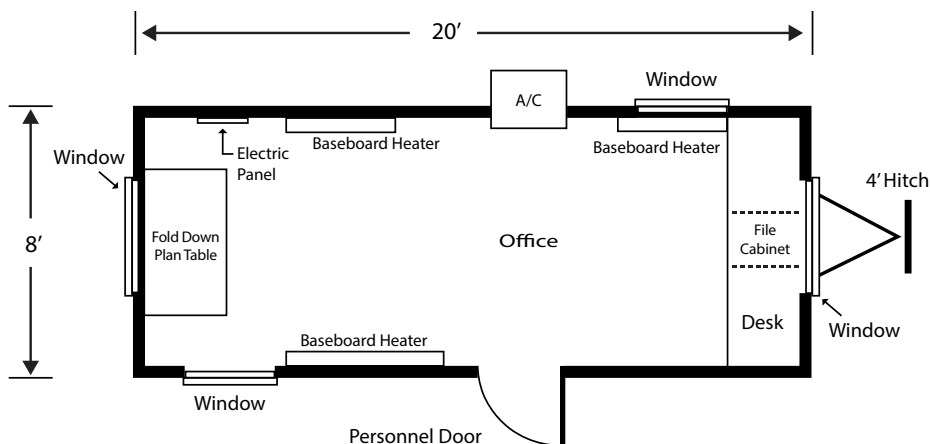
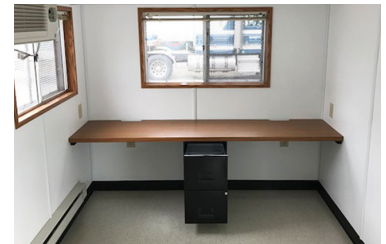

### Accessories

Ball Hitch Locks  
Hurricane Tiedowns  
Skirting



\* Photos are representational. Specifications may vary from those shown.

[eagleleasing.com/8-x20-single-office-trailer](http://eagleleasing.com/8-x20-single-office-trailer)

The Eagle Leasing Company

1-800-438-3245 - [info@eagleleasing.com](mailto:info@eagleleasing.com) - [eagleleasing.com](http://eagleleasing.com)

Orange, CT - Southborough, MA - Oxford, MA - Northborough, MA



1-800-GET-EAGLE  
1-800-438-3245

You See Us Everywhere®

## 8'x28' Office/Storage Trailer

[eagleleasing.com/get-a-quote](http://eagleleasing.com/get-a-quote)

Run your business on-site with Eagle Leasing's mobile office solutions.

### Size

- 8' x 28' trailer with 4' hitch
- Weight: 5,200 lbs
- 18' of storage space
- 10' of office space

### Electric

- Air conditioning and baseboard heating
- 100 amp, 120 volt breaker panel
- Interior ceiling lights
- 7 outlets (14 plugs)

### Interior

- (1) Built-in counter top desk (24" x 88")
- (1) Filing cabinet
- (1) Fold down planning table (36" x 60")
- (1) Wire shelf

### Exterior

- Aluminum siding
- (5) Windows with metal security screens
- (1) Lockable exterior door
- Rollup steel door to access storage area
- (1) Set of aluminum stairs (preassembled)

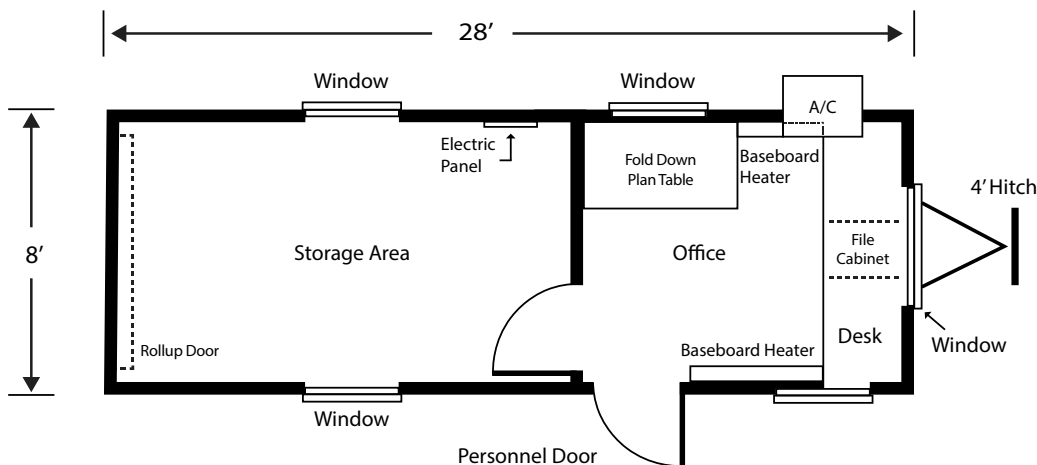

### Accessories

Ball Hitch Locks  
Hurricane Tiedowns  
Skirting



[eagleleasing.com/8x28-office-trailer](http://eagleleasing.com/8x28-office-trailer)

\* Photos are representational. Specifications may vary from those shown.

The Eagle Leasing Company  
1-800-438-3245 - [info@eagleleasing.com](mailto:info@eagleleasing.com) - [eagleleasing.com](http://eagleleasing.com)  
Orange, CT - Southborough, MA - Oxford, MA - Northborough, MA



1-800-GET-EAGLE  
1-800-438-3245

You See Us Everywhere®

## 8'x32' Double Office Trailer

[eagleleasing.com/get-a-quote](http://eagleleasing.com/get-a-quote)

Run your business on-site with Eagle Leasing's mobile office solutions.

### Size

- 8' x 32' trailer with 4' hitch
- Weight: 6,200 lbs

### Electric

- Air conditioning and baseboard heating
- 100 amp, 120 volt breaker panel
- Interior ceiling lights
- 11 outlets (22 plugs)

### Interior

- (2) Built-in counter top desks (24" x 88")
- (2) Filing cabinets
- (1) Fold down planning table (36" x 60")
- (2) Wire shelves

### Exterior

- Aluminum siding
- (6) Windows with metal security screens
- (2) Lockable steel exterior doors
- (2) Sets of aluminum stairs (preassembled)

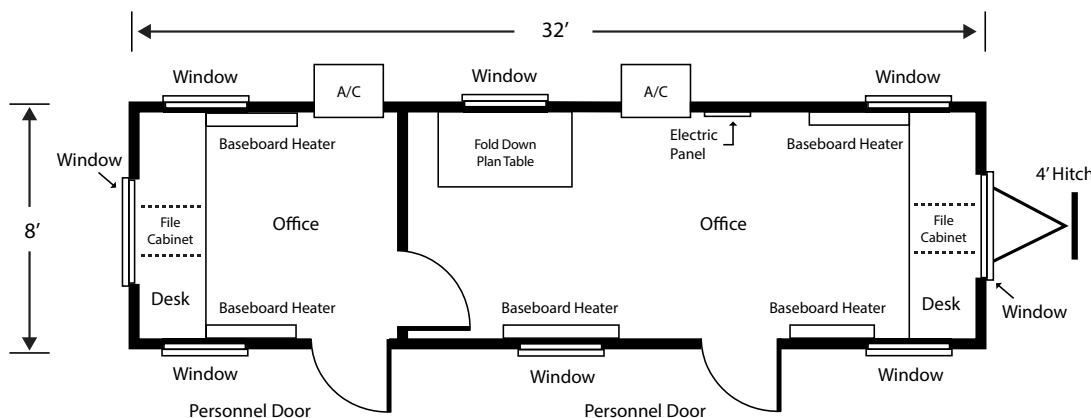

### Accessories

Ball Hitch Locks  
Hurricane Tiedowns  
Skirting



\* Photos are representational. Specifications may vary from those shown.

[eagleleasing.com/8x32-office-trailer](http://eagleleasing.com/8x32-office-trailer)

The Eagle Leasing Company  
1-800-438-3245 - [info@eagleleasing.com](mailto:info@eagleleasing.com) - [eagleleasing.com](http://eagleleasing.com)  
Orange, CT - Southborough, MA - Oxford, MA - Northborough, MA



1-800-GET-EAGLE  
1-800-438-3245

You See Us Everywhere®

## 10'x40' Triple Office Trailer

[eagleleasing.com/get-a-quote](http://eagleleasing.com/get-a-quote)

Run your business on-site with Eagle Leasing's mobile office solutions.

### Size

- 10' x 40' trailer with 4' hitch
- Weight: 11,200 lbs

### Electric

- Central air conditioning and heat
- 100 amp, 208/220 volt breaker panel
- Interior ceiling lights
- 12 outlets (24 plugs)

### Interior

- (2) Built-in counter top desks (24" x 88")
- (2) Filing cabinets
- (1) Fold down planning table (36" x 60")
- (2) Wire shelves

### Exterior

- Aluminum siding
- (5) Windows with metal security screens
- (2) Lockable steel exterior doors
- (2) Sets of aluminum stairs (preassembled)

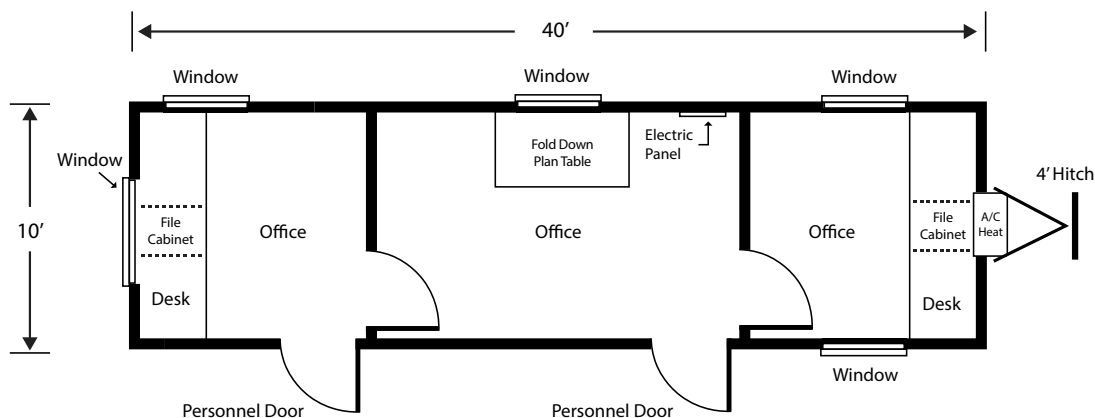
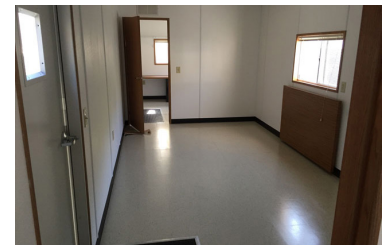

### Accessories

Ball Hitch Locks  
Hurricane Tiedowns  
Skirting



\* Photos are representational. Specifications may vary from those shown.

[eagleleasing.com/10x40-office-trailer](http://eagleleasing.com/10x40-office-trailer)

The Eagle Leasing Company  
1-800-438-3245 - [info@eagleleasing.com](mailto:info@eagleleasing.com) - [eagleleasing.com](http://eagleleasing.com)  
Orange, CT - Southborough, MA - Oxford, MA - Northborough, MA





1-800-GET-EAGLE  
1-800-438-3245

You See Us Everywhere®

## 10' Office Container (Guard Shack)

[eagleleasing.com/get-a-quote](http://eagleleasing.com/get-a-quote)

Run your business on-site with Eagle Leasing's mobile office solutions.

### Size

- 10' x 8' x 8'6" steel ISO container
- Weight: 5,027 lbs

### Interior

- (1) Built-in counter top desk (30" x 96")
- (1) Filing cabinet
- Pebbled fiberglass interior wall panels
- Marine grade plywood floor with epoxy finish

### Electric

- Air conditioning & heat
- 125 amp, 208/220 volt breaker panel
- Interior & exterior lights
- 2 outlets (4 plugs)
- 1 phone jack

### Exterior

- Reinforced corrugated steel
- (4) Windows with security bars
- Lockable steel exterior door with door closer
- (1) GFI outlet (2 plugs)

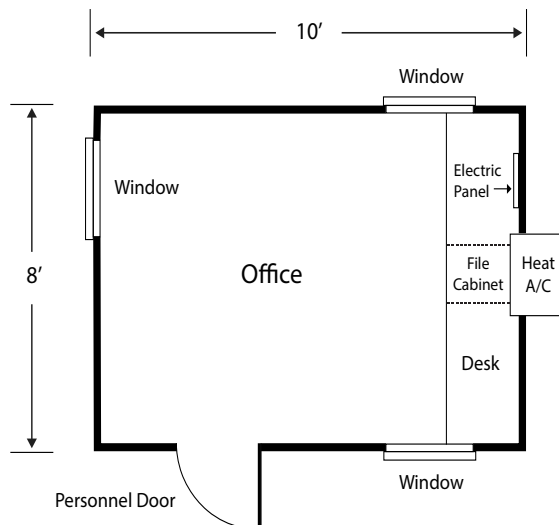

[eagleleasing.com/guard-shacks](http://eagleleasing.com/guard-shacks)

\* Photos are representational. Specifications may vary from those shown.

The Eagle Leasing Company  
1-800-438-3245 - [info@eagleleasing.com](mailto:info@eagleleasing.com) - [eagleleasing.com](http://eagleleasing.com)  
Orange, CT - Southborough, MA - Oxford, MA - Northborough, MA