

1-800-GET-EAGLE
1-800-438-3245



Mobile Office Solutions



eagleleasing.com
info@eagleleasing.com



1-800-GET-EAGLE
1-800-438-3245

You See Us Everywhere®

10' Office Container(Guard Shack)

eagleleasing.com/get-a-quote

Run your business on-site with Eagle Leasing's mobile office solutions.

Size

- 10' x 8' x 8'6" steel ISO container
- Weight: 5,027 lbs

Interior

- (1) Built-in counter top desk(30" x 96")
- (1) Filing cabinet
- Pebbled fiberglass interior wall panels
- Marine grade plywood floor with epoxy finish

Electric

- Air conditioning & heat
- 125 amp, 208/220 volt breaker panel
- Interior & exterior lights
- 2 outlets(4 plugs)
- 1 phone jack

Exterior

- Reinforced corrugated steel
- (2) Windows with security bars
- Lockable steel exterior door with door closer
- (1) GFI outlet(2 plugs)

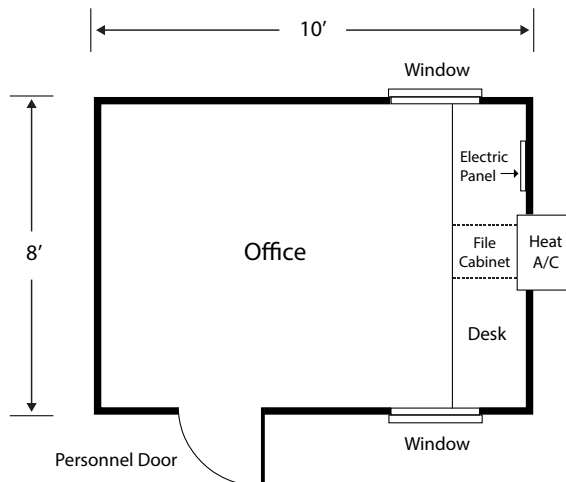

* Photos are representational. Specifications may vary from those shown.



eagleleasing.com/guard-shacks



1-800-GET-EAGLE
1-800-438-3245

You See Us Everywhere®

20' Office Container

eagleleasing.com/get-a-quote

Run your business on-site with Eagle Leasing's mobile office solutions.

Size

- 20' x 8' x 8'6" steel ISO container
- Weight : 7,079 lbs

Interior

- (1) Built-in counter top desk(30" x 96")
- (1) Filing cabinet
- (1) Folding plan table(32" x 60")
- Pebbled fiberglass interior wall panels
- Marine grade plywood floor with epoxy finish

Electric

- Central air conditioning & heat
- 125 amp, 208/220 volt breaker panel
- Interior & exterior lights
- 4 outlets (12 plugs)
- 1 phone jack

Exterior

- Reinforced corrugated steel
- (4) Windows with security bars
- Lockable steel exterior door with door closer
- (1) GFI outlet(2 plugs)

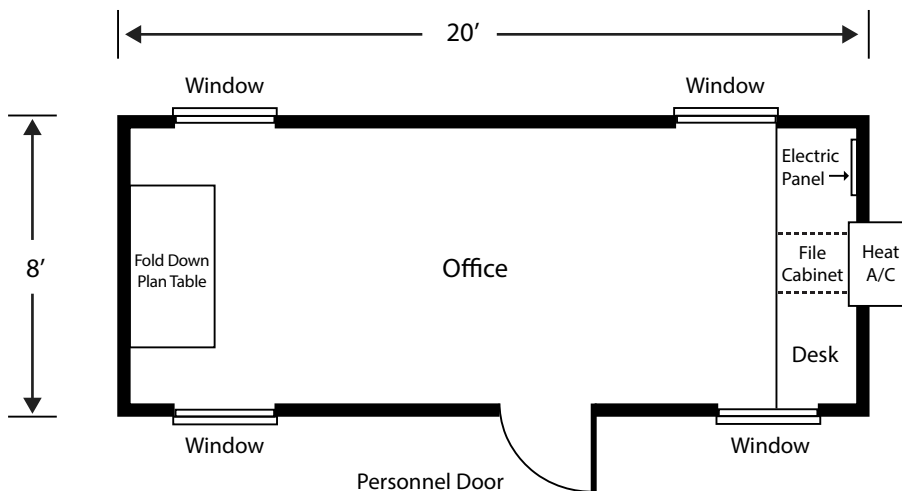

* Photos are representational. Specifications may vary from those shown.



eagleleasing.com/20-office-containers



1-800-GET-EAGLE
1-800-438-3245

You See Us Everywhere®

20' Office/Storage Container

eagleleasing.com/get-a-quote

Run your business on-site with Eagle Leasing's mobile office solutions.



Size

- 20' x 8' x 8'6" steel ISO container
- Weight: 6,435 lbs
- 10' of storage space
- 10' of office space

Electric

- Air conditioning & heat
- 125 amp, 208/220 volt breaker panel
- Interior & exterior lights
- 3 outlets(10 plugs)
- 1 phone jack



Interior

- (1) Built-in counter top desk(30" x 96")
- (1) Filing cabinet
- (1) Folding plan table(32" x 60")
- Pebbled fiberglass interior wall panels
- Marine grade plywood floor with epoxy finish
- Steel interior door

Exterior

- Reinforced corrugated steel
- (2) Windows with security bars
- Lockable steel exterior door with door closer
- (1) GFI outlet(2 plugs)

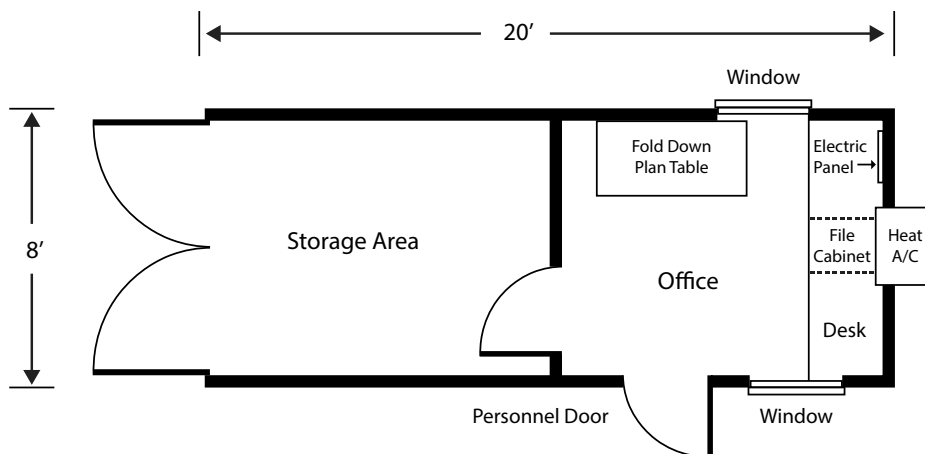

Accessories

- Eagle Locks®
- Shelves
- Pipe Racks
- Container Ramps
- Fork Truck Ramps



* Photos are representational. Specifications may vary from those shown.

eagleleasing.com/20-office-storage-container



1-800-GET-EAGLE
1-800-438-3245

You See Us Everywhere®

20' Open Office/Breakroom Container

eagleleasing.com/get-a-quote

Run your business on-site with Eagle Leasing's mobile office solutions.

Size

- 20' x 8' x 8'6" steel ISO container
- Weight : 6,979 lbs

Interior

- Pebbled fiberglass interior wall panels
- Marine grade plywood floor with epoxy finish

Electric

- Central air conditioning & heat
- 125 amp, 208/220 volt breaker panel
- Interior & exterior lights
- 4 outlets (12 plugs)
- 1 phone jack

Exterior

- Reinforced corrugated steel
- (4) Windows with security bars
- Lockable steel exterior door with door closer
- (1) GFI outlet(2 plugs)

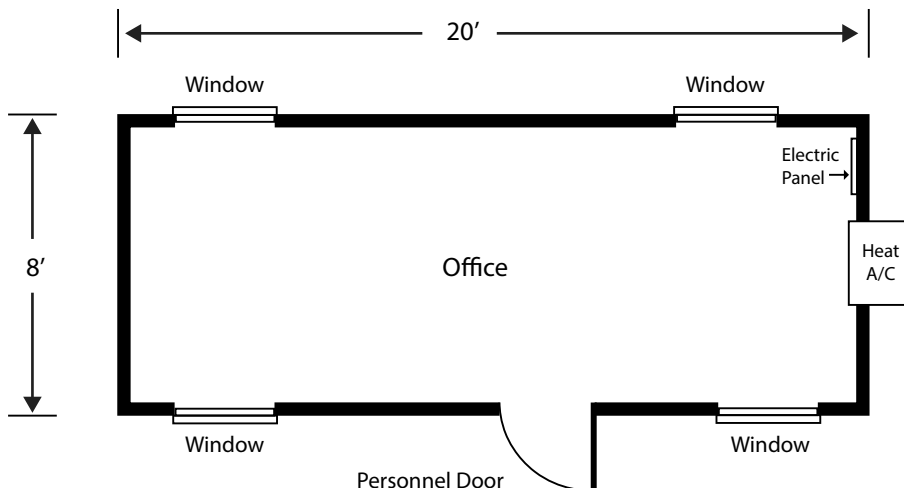

* Photos are representational. Specifications may vary from those shown.



eagleleasing.com/20-office-containers



1-800-GET-EAGLE
1-800-438-3245

You See Us Everywhere®

40' Office/Storage Container

eagleleasing.com/get-a-quote

Run your business on-site with Eagle Leasing's mobile office solutions.

Size

- 40' x 8' x 9'6" steel ISO container
- Weight: 11,103 lbs
- 25' of storage space
- 15' of office space

Interior

- (1) Built-in counter top desk(30" x 96")
- (1) Filing cabinet
- (1) Folding plan table(32" x 60")
- Pebbled fiberglass interior wall panels
- Marine grade plywood floor with epoxy finish
- Steel interior door

Electric

- Air conditioning & heat
- 125 amp, 208/220 volt breaker panel
- Interior & exterior lights
- 3 outlets (10 plugs)
- 1 phone jack

Exterior

- Reinforced corrugated steel
- (2) Windows with security bars
- Lockable steel exterior door with door closer
- (1) GFI outlet(2 plugs)

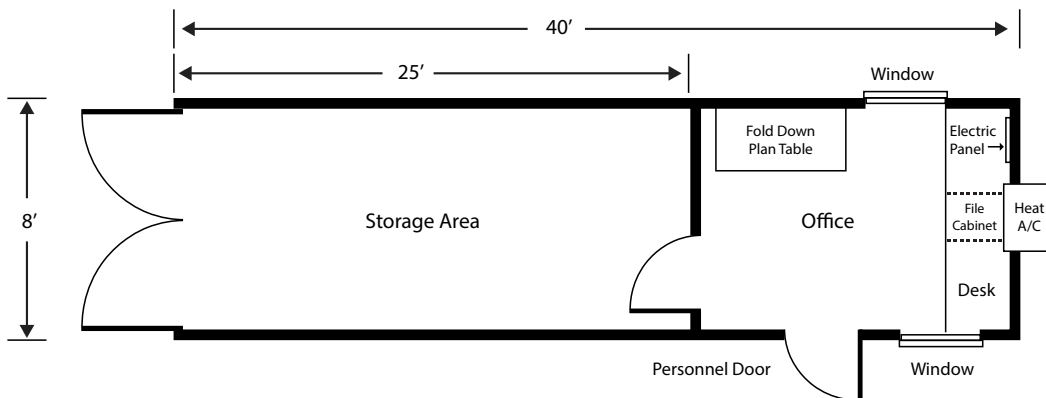

Accessories

Eagle Locks®
Shelves
Pipe Racks
Container Ramps
Fork Truck Ramps



* Photos are representational. Specifications may vary from those shown.

eagleleasing.com/40-office-storage-container

The Eagle Leasing Company
1-800-438-3245 - info@eagleleasing.com - eagleleasing.com
Orange, CT - Southborough, MA - Oxford, MA - Northborough, MA



1-800-GET-EAGLE
1-800-438-3245

You See Us Everywhere®

40' Triple Office Container

eagleleasing.com/get-a-quote

Run your business on-site with Eagle Leasing's mobile office solutions.

Size

- 40' x 8' x 9'6" steel ISO container
- Weight: 14,148 lbs

Interior

- (2) Built-in counter top desks(30" x 96")
- (2) Filing cabinets
- (1) Folding plan table(32" x 60")
- Pebbled fiberglass interior wall panels
- Marine grade plywood floor with epoxy finish
- (2) Steel interior doors

Electric

- Central air conditioning & heat
- 125 amp, 208/220 volt breaker panel
- Interior & exterior lights
- 10 outlets(28 plugs)
- 2 phone jack

Exterior

- Reinforced corrugated steel
- (6) Windows with security bars
- (2) Lockable steel exterior doors with door closers
- (1) GFI outlet(2 plugs)

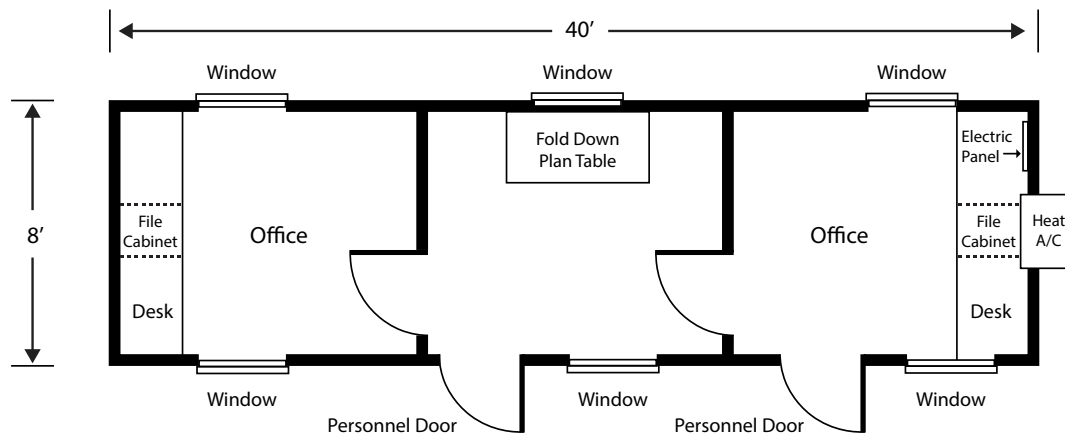

* Photos are representational. Specifications may vary from those shown.



eagleleasing.com/40-triple-office-container



1-800-GET-EAGLE
1-800-438-3245

You See Us Everywhere®

40' Open Office/Breakroom Container

eagleleasing.com/get-a-quote

Run your business on-site with Eagle Leasing's mobile office solutions.

Size

- 40' x 8' x 9'6" steel ISO container
- Weight: 12,247 lbs

Electric

- Central air conditioning & heat
- 125 amp, 208/220 volt breaker panel
- Interior & exterior lights
- 8 outlets(20 plugs)
- 2 phone jack



Interior

- (1) Built-in counter top desks(30" x 96")
- (1) Filing cabinets
- Pebbled fiberglass interior wall panels
- Marine grade plywood floor with epoxy finish

Exterior

- Reinforced corrugated steel
- (5) Windows with security bars
- (2) Lockable steel exterior doors with door closers
- (1) GFI outlet(2 plugs)

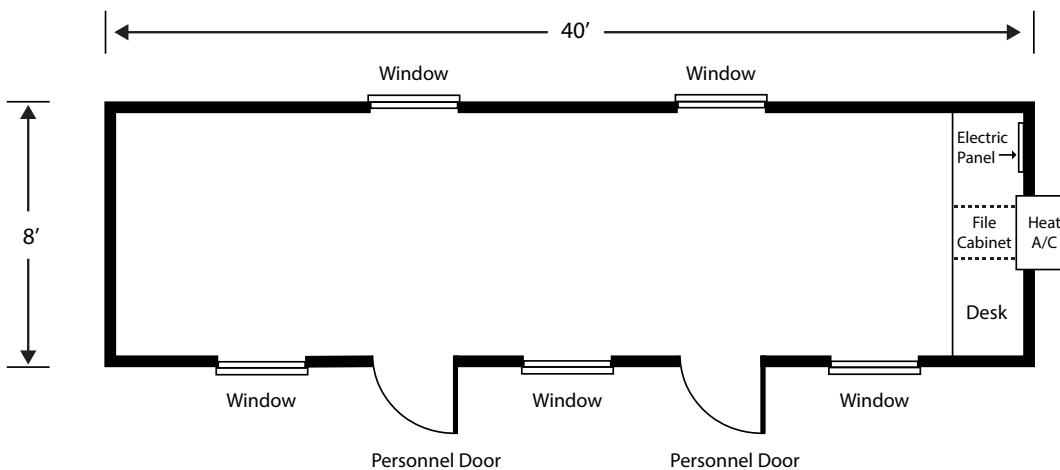

* Photos are representational. Specifications may vary from those shown.

The Eagle Leasing Company
1-800-438-3245 - info@eagleleasing.com - eagleleasing.com
Orange, CT - Southborough, MA - Oxford, MA - Northborough, MA



1-800-GET-EAGLE
1-800-438-3245

You See Us Everywhere®

40' Breakroom Container

eagleleasing.com/get-a-quote

Run your business on-site with Eagle Leasing's mobile office solutions.



Size

- 40' x 8' x 8'6" steel ISO container
- Weight: 10,622 lbs

Electric

- Air conditioning and baseboard heating
- 125 amp, 208/220 volt breaker panel
- Interior & exterior lights
- 8 outlets(16 plugs)



Interior

- (2) Baseboard heaters
- Marine grade plywood floor with epoxy finish

Exterior

- Reinforced corrugated steel
- (2) Lockable steel exterior doors

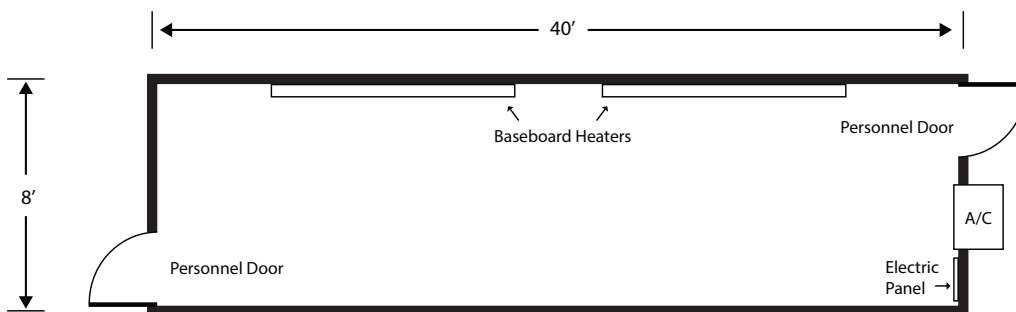

eagleleasing.com/breakroom-container

* Photos are representational. Specifications may vary from those shown.

The Eagle Leasing Company
1-800-438-3245 - info@eagleleasing.com - eagleleasing.com
Orange, CT - Southborough, MA - Oxford, MA - Northborough, MA



1-800-GET-EAGLE
1-800-438-3245

You See Us Everywhere®

8'x20' Single Office Trailer

eagleleasing.com/get-a-quote

Run your business on-site with Eagle Leasing's mobile office solutions.

Size

- 8' x 20' trailer with 4' hitch
- Weight: 3,900 lbs

Electric

- Air conditioning and baseboard heating
- 100 amp, 120 volt breaker panel
- Interior ceiling lights
- 5 outlets(10 plugs)



Interior

- (1) Built-in counter top desk(24" x 88")
- (1) Filing cabinet
- (1) Fold down planning table(36" x 60")
- (1) Wire shelf

Exterior

- Aluminum siding
- (3) Windows with metal security screens
- (1) Lockable steel exterior door
- (1) Set of aluminum stairs

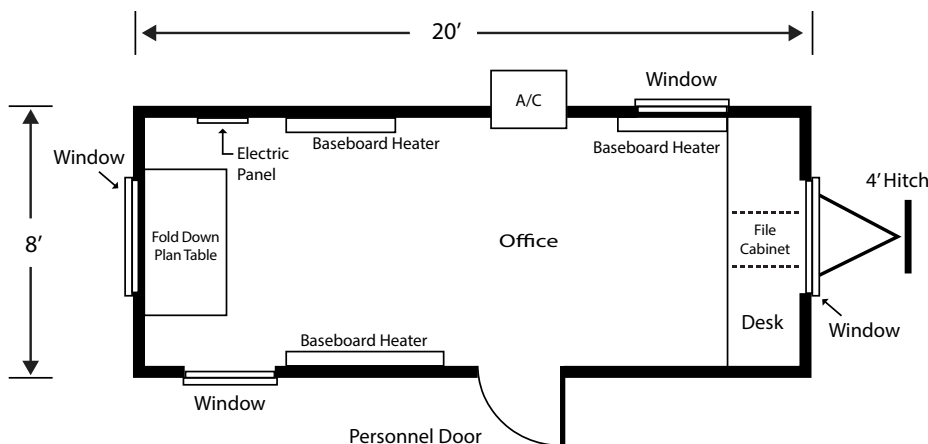
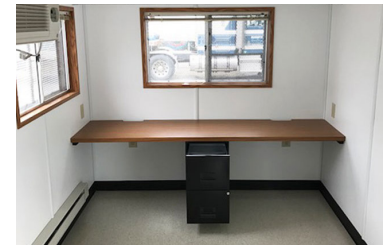

Accessories

- Ball Hitch Locks
- Hurricane Tiedowns
- Skirting



* Photos are representational. Specifications may vary from those shown.

eagleleasing.com/8-x20-single-office-trailer

The Eagle Leasing Company
1-800-438-3245 - info@eagleleasing.com - eagleleasing.com
Orange, CT - Southborough, MA - Oxford, MA - Northborough, MA



1-800-GET-EAGLE
1-800-438-3245

You See Us Everywhere®

8'x28' Office/Storage Trailer

eagleleasing.com/get-a-quote

Run your business on-site with Eagle Leasing's mobile office solutions.

Size

- 8' x 28' trailer with 4' hitch
- Weight: 5,200 lbs
- 18' of storage space
- 10' of office space

Electric

- Air conditioning and baseboard heating
- 100 amp, 120 volt breaker panel
- Interior ceiling lights
- 7 outlets(14 plugs)

Interior

- (1) Built-in counter top desk(24" x 88")
- (1) Filing cabinet
- (1) Fold down planning table(36" x 60")
- (1) Wire shelf

Exterior

- Aluminum siding
- (5) Windows with metal security screens
- (1) Lockable exterior door
- Rollup steel door to access storage area
- (1) Set of aluminum stairs

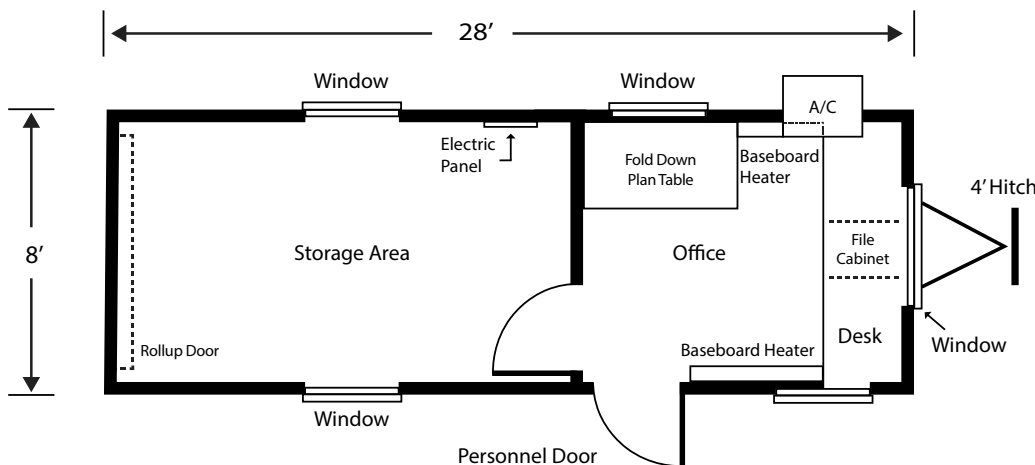

Accessories

- Ball Hitch Locks
- Hurricane Tiedowns
- Skirting



eagleleasing.com/8x28-office-trailer

* Photos are representational. Specifications may vary from those shown.

The Eagle Leasing Company
1-800-438-3245 - info@eagleleasing.com - eagleleasing.com
Orange, CT - Southborough, MA - Oxford, MA - Northborough, MA



1-800-GET-EAGLE
1-800-438-3245

You See Us Everywhere®

8'x32' Double Office Trailer

eagleleasing.com/get-a-quote

Run your business on-site with Eagle Leasing's mobile office solutions.

Size

- 8' x 32' trailer with 4' hitch
- Weight: 6,200 lbs

Electric

- Air conditioning and baseboard heating
- 100 amp, 120 volt breaker panel
- Interior ceiling lights
- 11 outlets(22 plugs)



Interior

- (2) Built-in counter top desks(24" x 88")
- (2) Filing cabinets
- (1) Fold down planning table(36" x 60")
- (2) Wire shelves

Exterior

- Aluminum siding
- (6) Windows with metal security screens
- (2) Lockable steel exterior doors
- (2) Sets of aluminum stairs

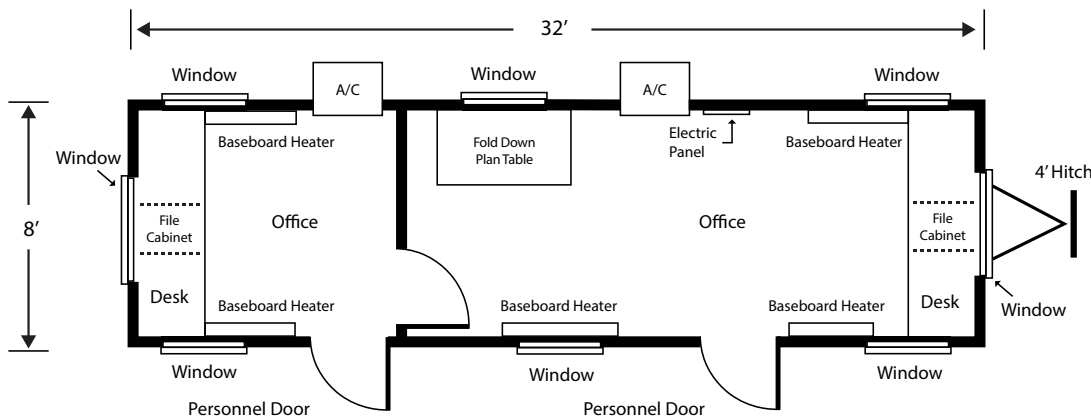

Accessories

- Ball Hitch Locks
- Hurricane Tiedowns
- Skirting



eagleleasing.com/8x32-office-trailer

* Photos are representational. Specifications may vary from those shown.

The Eagle Leasing Company
1-800-438-3245 - info@eagleleasing.com - eagleleasing.com
Orange, CT - Southborough, MA - Oxford, MA - Northborough, MA



1-800-GET-EAGLE
1-800-438-3245

You See Us Everywhere®

10'x40' Triple Office Trailer

eagleleasing.com/get-a-quote

Run your business on-site with Eagle Leasing's mobile office solutions.

Size

- 10' x 40' trailer with 4' hitch
- Weight: 11,200 lbs

Electric

- Central air conditioning and heat
- 100 amp, 208/220 volt breaker panel
- Interior ceiling lights
- 12 outlets(24 plugs)



Interior

- (2) Built-in counter top desks(24" x 88")
- (2) Filing cabinets
- (1) Fold down planning table(36" x 60")
- (2) Wire shelves

Exterior

- Aluminum siding
- (5) Windows with metal security screens
- (2) Lockable steel exterior doors
- (2) Sets of aluminum stairs

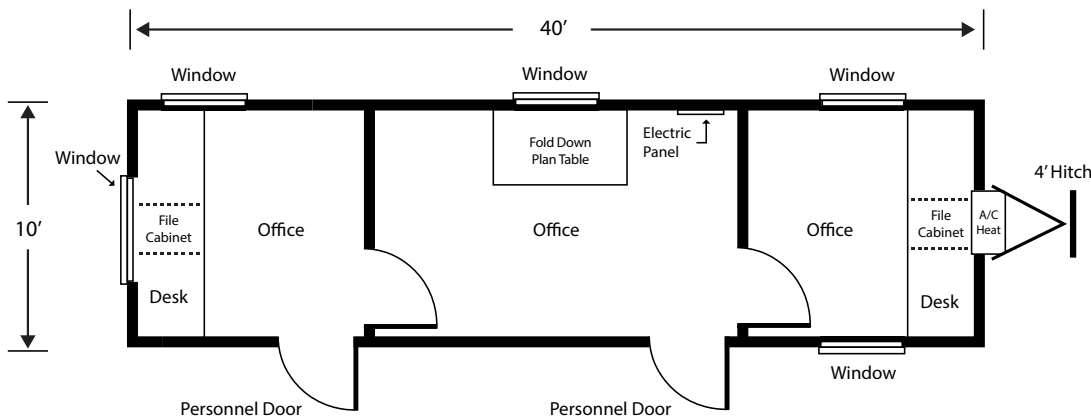

Accessories

- Ball Hitch Locks
- Hurricane Tiedowns
- Skirting



eagleleasing.com/10x40-office-trailer

* Photos are representational. Specifications may vary from those shown.

The Eagle Leasing Company
1-800-438-3245 - info@eagleleasing.com - eagleleasing.com
Orange, CT - Southborough, MA - Oxford, MA - Northborough, MA